

## Rundklinkenzüge

## Round latch locks

## Crochets cylindriques

DLC 

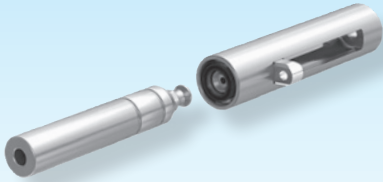

S1max.	L1	L2	L3	L4	S1max.	L1	L2	L3	L4
50	125	130	76	50	125	275	205	151	50
50	175	130	76	50	125	325	205	151	50
50	225	130	76	50	150	275	230	176	50
75	175	155	101	50	150	325	230	176	50
75	225	155	101	50	175	275	255	201	50
100	175	180	126	50	175	325	255	201	50
100	225	180	126	50					

Z3-3-  
Z3-31-

**i** deutsch 6.20-26  
english 6.27-33  
français 6.34-40

 Z3-3-S1max-L1  
Z3-31-S1max-L1

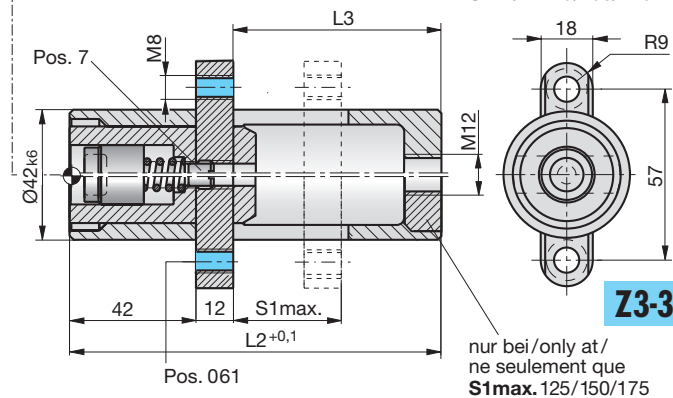
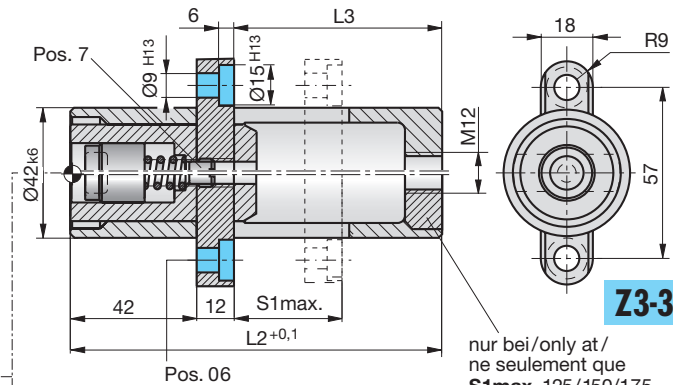
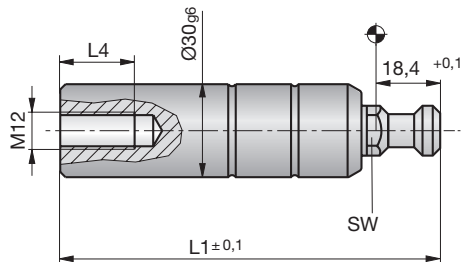

Distanzscheiben  
Distance washers  
Cale d'épaisseur

Mat.Nr.: 1.2767/-54HRC

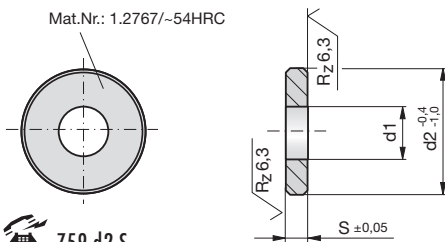

 Z59-d2-S

d2	S	d1	d2	S	d1
29,9	5	13	41,9	5	13
29,9	10	13	41,9	10	13

Einbau als Klinkenzug  
Installation as latch lock  
Montage d'Ouvres-moules

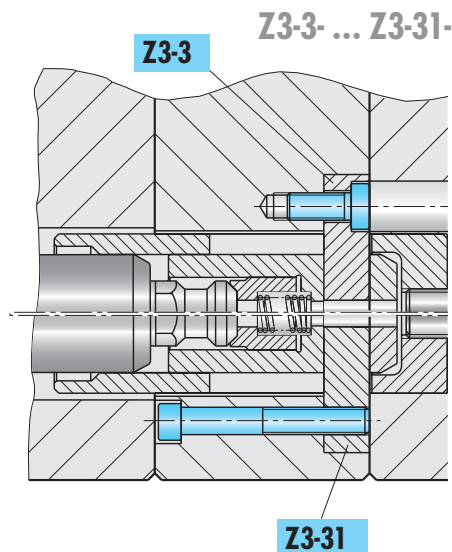
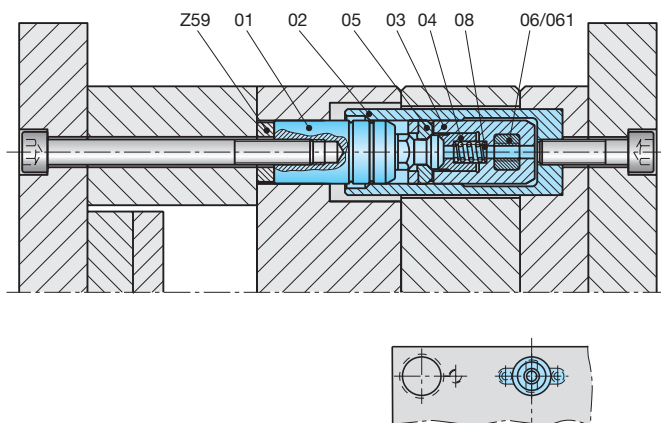

Einbau als Zweistufenauswerfer  
Installation as Two stage ejector  
Montage d'éjecteur a deux etages

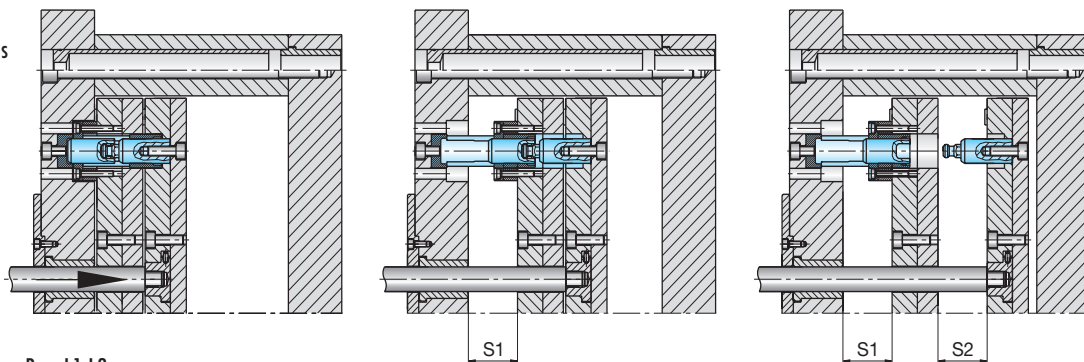

Stückliste  
Parts list  
Liste des pièces

Z3-Type-Pos.-L1-L2

Type	Pos. Item Pos.	L1	L2	Stück Quant. Nbr.	Bezeichnung	Description	Désignation	Mat.-Nr. Mat.-No Mat.Nr.
3/31	01	125	-	1	Zugbolzen	Latch bar	Colonne d'attelage	1.5920
	01	175	-	1	Zugbolzen	Latch bar	Colonne d'attelage	1.5920
	01	225	-	1	Zugbolzen	Latch bar	Colonne d'attelage	1.5920
	01	275	-	1	Zugbolzen	Latch bar	Colonne d'attelage	1.5920
	01	325	-	1	Zugbolzen	Latch bar	Colonne d'attelage	1.5920
3/31	02	-	130	1	Gehäuse	Housing	Boîtier cylindrique fendu	1.5920
	02	-	155	1	Gehäuse	Housing	Boîtier cylindrique fendu	1.5920
	02	-	180	1	Gehäuse	Housing	Boîtier cylindrique fendu	1.5920
	02	-	205	1	Gehäuse	Housing	Boîtier cylindrique fendu	1.5920
	02	-	230	1	Gehäuse	Housing	Boîtier cylindrique fendu	1.5920
	02	-	255	1	Gehäuse	Housing	Boîtier cylindrique fendu	1.5920
3/31	03	-	-	1	Kolben	Piston	Piston	DLC
	04	-	-	1	Sicherungsbuchse	Securing ring	Manchon de retenue	SN
	05	-	-	2	Rasten	Catches	Clavettes d'arrêt	DLC
3	06	-	-	1	Mitnehmer	Driver	Barrette d'entraînement	SN
31	061	-	-	1	Mitnehmer	Driver	Barrette d'entraînement	SN

Normalien  
Standard parts  
Elements standard

Strack Norm

Strack Norm	Pos. Item Pos.	Stück Quant. Nbr.	Bezeichnung	Description	Désignation	Mat.-Nr. Mat.-No Mat.Nr.
SN3610-M6-8	07	1	Gewindestift	Socket set screw	Vis fendue sans tête	SN
SN2500-9-35	08	1	Feder	Spring	Ressort	SN

Klinkenzüge

Latch locks

Ouvres-moules

## CAD-INFO

