

Verlängerte Traverse
Extended steady
Tasseau prolongée

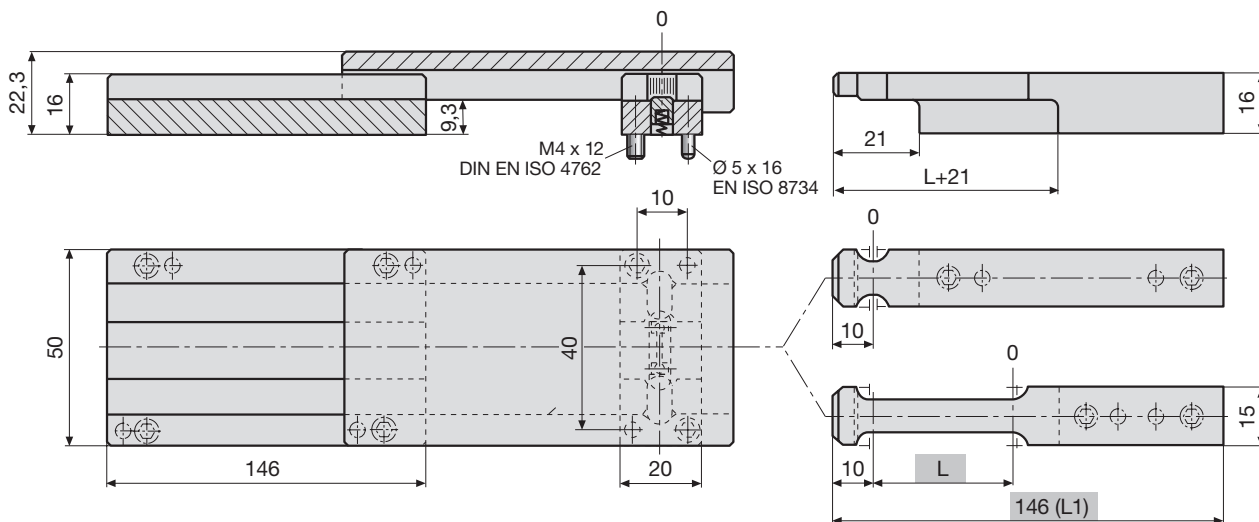

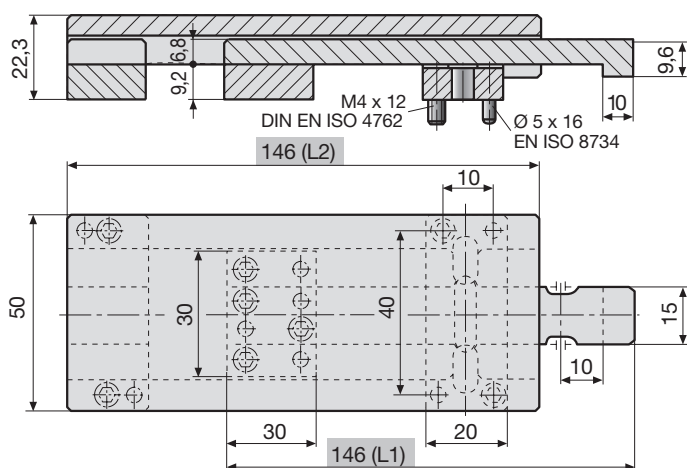





Type	L	Type	L
0-41	0	50-41	50
25-41	25	75-41	75

Zweistufenauswerfer
Two stage ejector
Éjecteur à deux étages



L , L1 , L2

in anderen Längen auf Anfrage
in other lengths on request
en autre longueurs sur demande

Klinkenzüge		Latch locks		Ouvres-moules	
Z4-1-	<p>i deutsch 6.84-94 english 6.95-105 français 6.106-116</p>				
 Z4-1-Type					
Z4-15-	<p>i deutsch 6.84-94 english 6.95-105 français 6.106-116</p>				
 Z4-15-Type					
Z4-2-	<p>i deutsch 6.84-94 english 6.95-105 français 6.106-116</p>				
 Z4-2-Type					

6

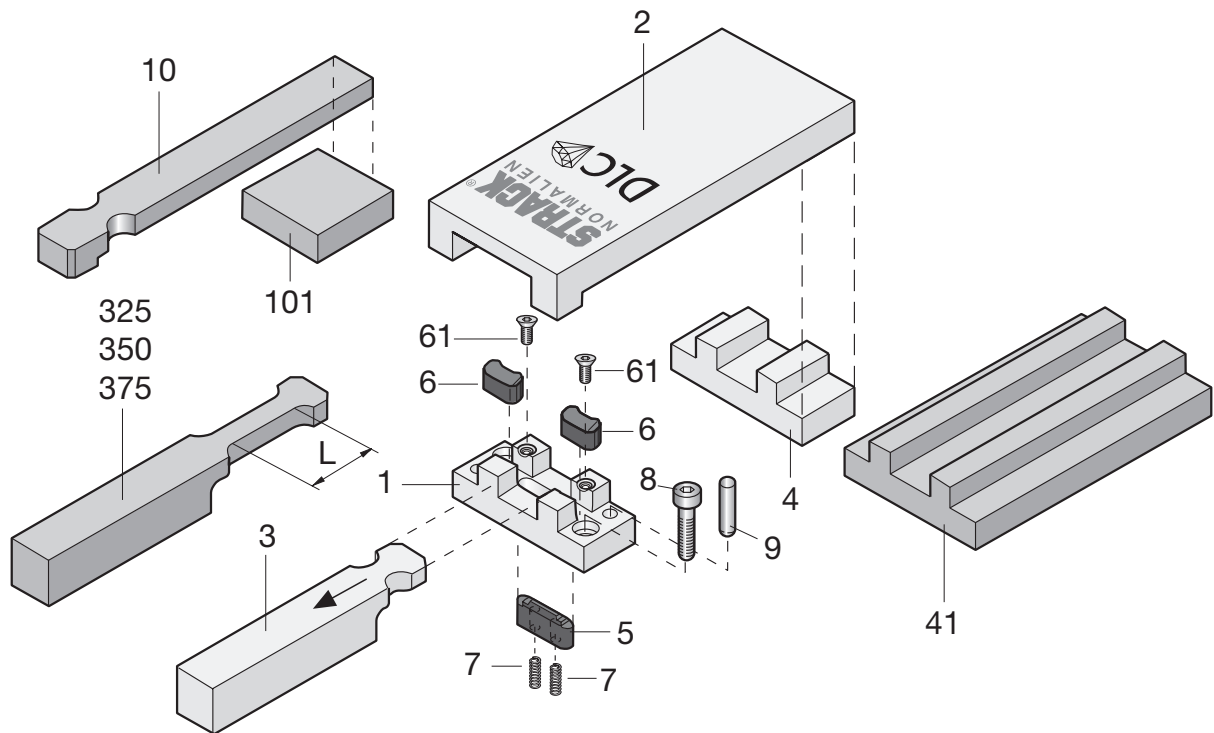

D 3002A 07.2018

Stückliste
Parts list
Liste des pièces



Type	Pos. Item Pos.	Stück Quant. Nbr.	Bezeichnung	Description	Désignation	Mat.-Nr. Mat.-No Mat.Nr.
01	1	1	Klinkengehäuse	Latch housing	Support mobile	
02	2	1	Steuerplatte	Control plate	Plaque support	1.2162 ¹⁾
03	3	1	Zugleiste	Latch bar	Crochet	1.2162 ¹⁾
0325	325	1	Zugleiste m. Verzögerung, L = 25 mm	Latch bar with delay, L = 25 mm	Crochet de traction à retardement, L = 25 mm	1.2162 ¹⁾
0350	350	1	Zugleiste m. Verzögerung, L = 50 mm	Latch bar with delay, L = 50 mm	Crochet de traction à retardement, L = 50 mm	1.2162 ¹⁾
0375	375	1	Zugleiste m. Verzögerung, L = 75 mm	Latch bar with delay, L = 75 mm	Crochet de traction à retardement, L = 75 mm	1.2162 ¹⁾
04	4	1	Traverse	Steady	Tasseau	1.1730
041	41	1	Traverse, lang	Long steady	Tasseau long	1.1730
05	5	1	Sperre	Catch stop	Verrou	DLC
06	6	2	Raste	Catch	Clavette	DLC
10	10	1	Ausstoßerleiste	Reverse latch bar	Poussoir	1.2162 ¹⁾
101	101	1	Unterlage	Spacer	Support	1.1730

¹⁾ ~ 630 HV10
Einatzhärtetiefe (Eht)
Thickness of hardened layer = 0,4 - 0,6 mm
Épaisseur de la couche durcie

Normalien
Standard parts
Elements standard



Strack Norm	Pos. Item Pos.	Stück Quant. Nbr.	Bezeichnung	Description	Désignation	Mat.-Nr. Mat.-No Mat.Nr.
SN3550-M3-6	61	2	Senkschraube	Countersunk screw	Vis à tête fraisée	SN
SN2500-3-12	7	2	Druckfeder	Spring	Ressort de pression du verrou	SN
SN3540-M4-12	8	2	Zylinderschraube	Cap screw	Vis 6 pans creux	SN
SN1973-5-16	9	2	Zylinderstift	Dowel pin	Goupille cylindrique	SN

Lieferumfang
Scope of delivery
Contenu de la livraison

Z4-1-0-0	Z4-1-25-0 Z4-1-50-0 Z4-1-75-0	Z4-1-0-41	Z4-1-25-41 Z4-1-50-41 Z4-1-75-41	Z4-1-1-0
01	01	01	01	01
02	02	02	02	02
03	0325	03	0325	
	0350		0350	
	0375		0375	
04	04	041	041	04
05	05	05	05	
06 + 061	06 + 061	06 + 061	06 + 061	06 + 061
07	07	07	07	
08	08	08	08	08
09	09	09	09	09
				10
				101

Klinkenzüge

Latch locks

Ouvres-moules

CAD-INFO

Z4-x-0-0

-25-

-50-

-75-

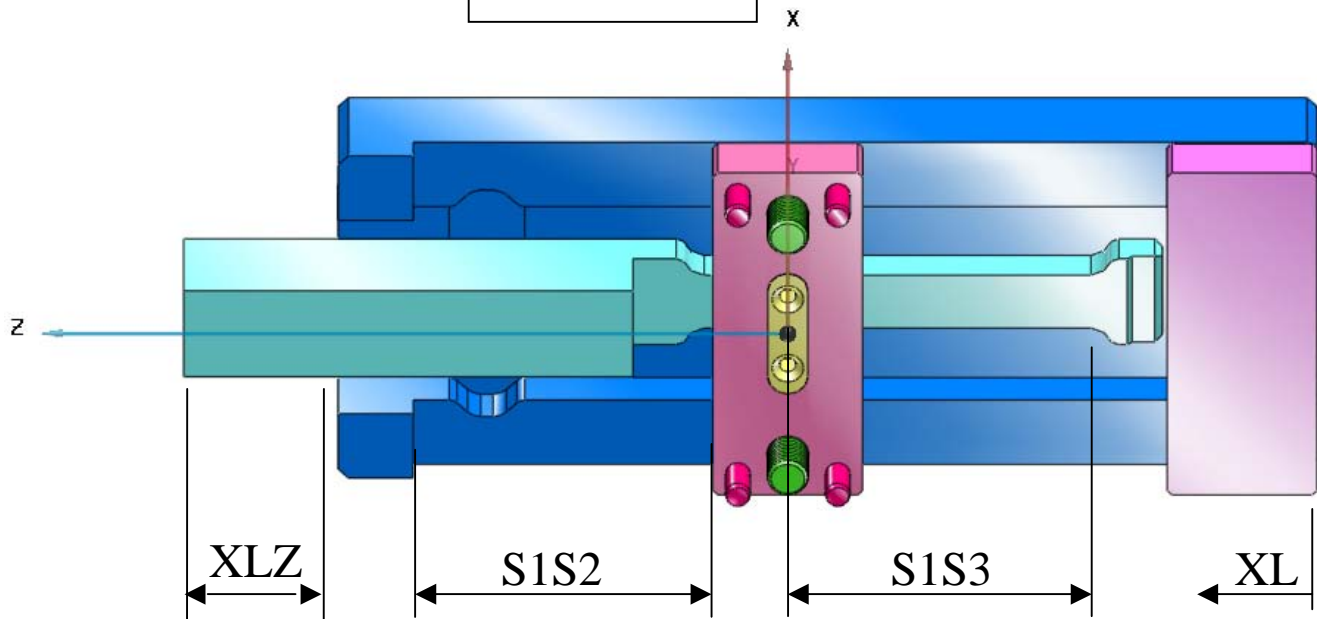
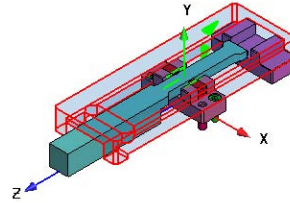

Z4-x-0-41

-25-41

-50-41

-75-41

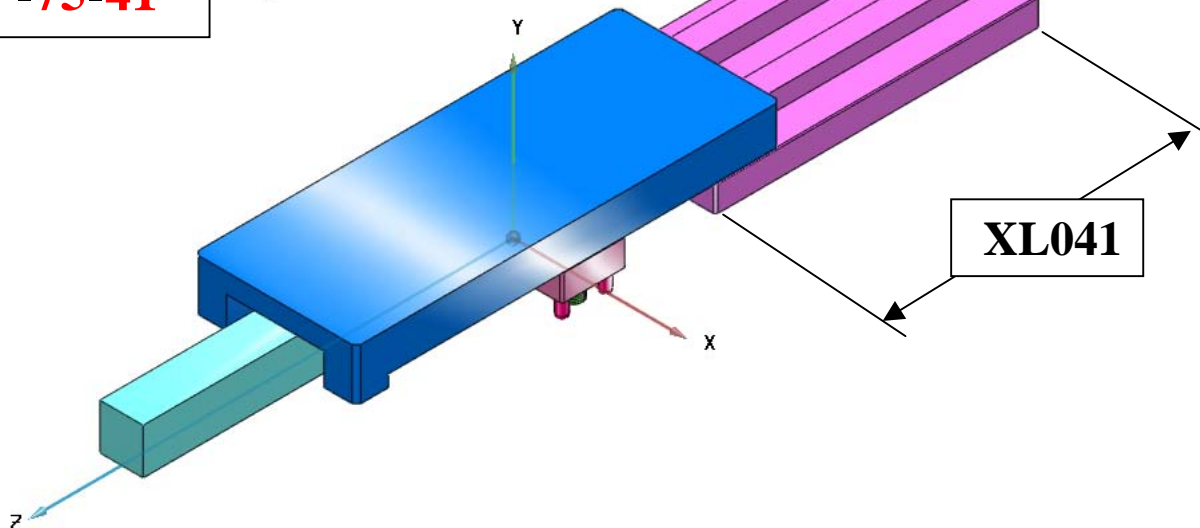
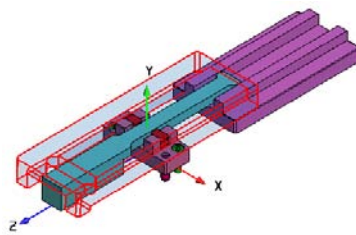

Klinkenzüge

Latch locks

Ouvres-moules

CAD-INFO

Z4-1-1-0

Z4-11-1-0

Z4-15-1-0

Z4-16-1-0

Z4-2-1-0

Z4-21-1-0

VAR=1

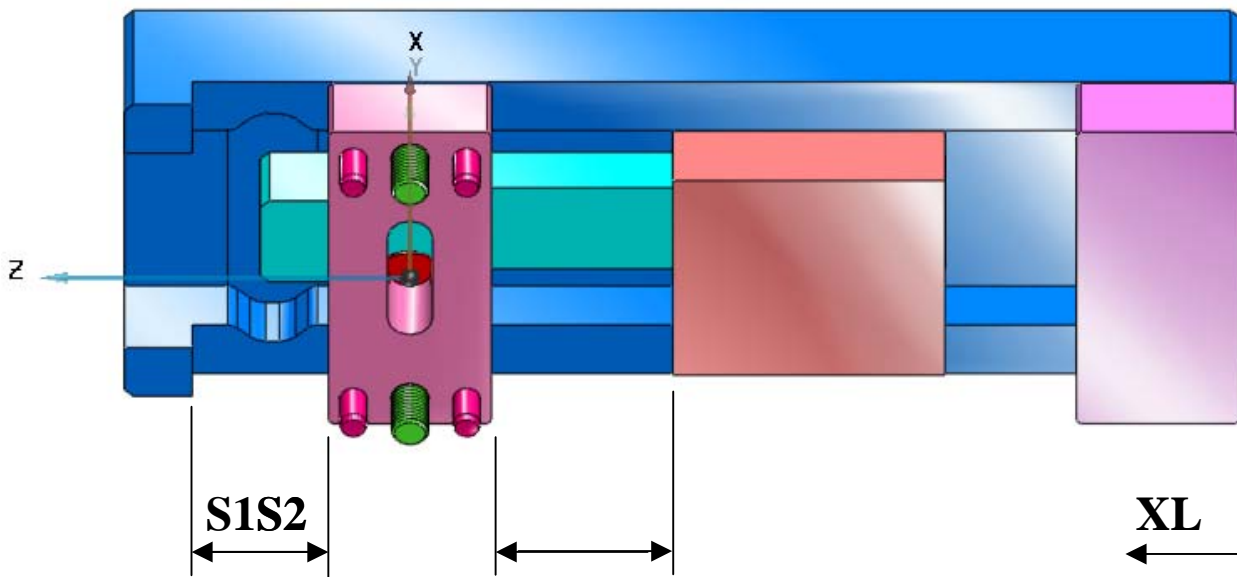
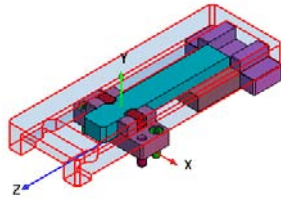

VAR=2

