

PMU

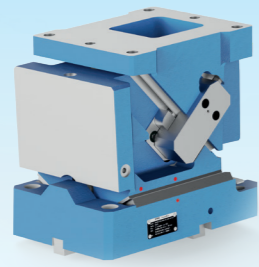

- ▶ Breiten von 65-1200 mm
- ▶ Arbeitswinkel 0-25°
- ▶ Durchschnittliche Lebensdauer: 2 Mio.
- ▶ Garantierte Standzeit: 1 Mio.
- ▶ *Widths from 65-1200 mm*
- ▶ *Working angle 0-25°*
- ▶ *Average lifetime: 2 million*
- ▶ *Guaranteed service life: 1 million*

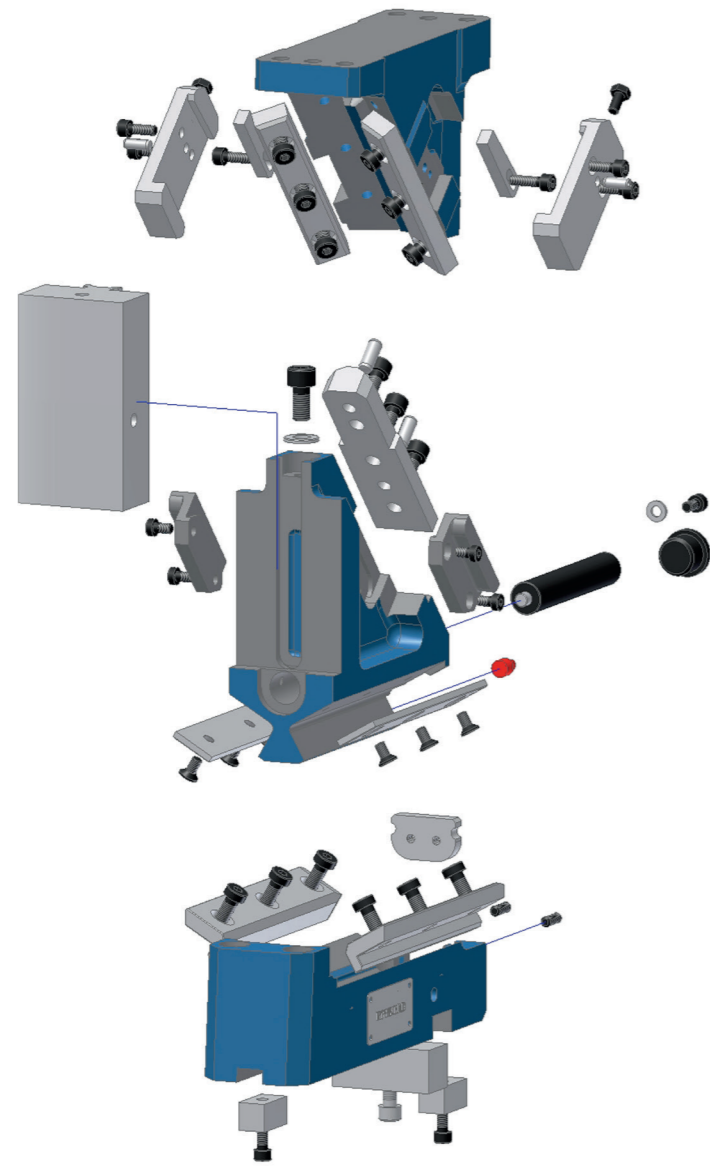

Freigaben der Autohersteller / Approvals of the car manufacturers: https://www.strack.de/de/powermax_freigaben/

Sonderschieber

Das PowerMax® Standard-Schieberprogramm deckt bereits eine Vielzahl von Größen und Schieberwinkeln ab. Eine individuelle Anpassung an die Werkzeugumgebung ist aber oft unumgänglich.

Hierzu gehören:

- ▶ Standardschieber mit Bearbeitungen nach Kundenvorgabe (Bohrungen, Gewinde, Taschen usw.)
- ▶ Schieber in gewünschten Zwischenwinkeln (auch außerhalb der 5° Stufung bis 80° für die Bearbeitung hochfester Bleche unumgänglich) sowie negative Winkel möglich
- ▶ Verbreiterung bzw. Erhöhung der Arbeitsfläche
- ▶ Schieber mit Sondermontageplatten
- ▶ Freimachung für Greifersysteme
- ▶ Zugschieber
- ▶ Patentierter Multiguide-Schieber



Special slide

The PowerMax® standard slide program already covers a wide range of sizes and slide angles. However, individual adaptation to the die environment is often unavoidable.

These include:

- ▶ Standard cams with machining according to customer specifications (bores, threads, pockets, etc.)
- ▶ Slides in desired intermediate angles (also outside the 5° step up to 80° indispensable for machining high-strength sheet metal) as well as negative angles possible
- ▶ Widening or raising of the working surface
- ▶ Cams with special mounting plates
- ▶ Clearance for gripper systems
- ▶ Pulling slider
- ▶ Patented Multiguide cam unit



STRACK NORMA GmbH & Co. KG

Königsberger Str. 11
D-58511 Lüdenscheid
Postfach 16 29
D-58466 Lüdenscheid

Tel +49 2351 8701-0
Fax +49 2351 8701-100
Mail info@strack.de
Web www.strack.de



SCHIEBERPROGRAMM CAM UNIT RANGE

Klein und
SUPERKRÄFTIG.
*Small and
super strong.*



STRACK® NORMALIEN

PMO	PMOK	PMOL	PMOKL	PMU
				
Standard	Super-kompakt	Light	Super-kompakt light	Standard

Herausstellungsmerkmale

Distinguishing features

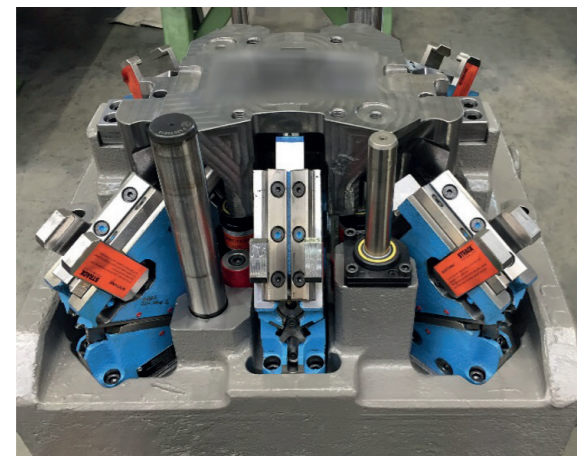
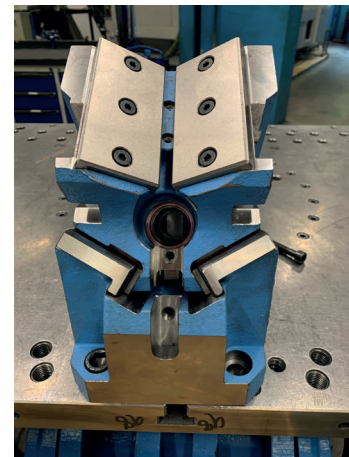

- Prismatische-Schwabenschwanzführung
- Weltweit genauestes Führungskonzept bei Schiebern
- Prismatic-Dovetail guide
- World's most precise guiding concept for cam units

- Schieber speziell für enge Platzverhältnisse durch die bis zu 30 % geringere Einbautiefe
- Cam especially for narrow spaces due to the up to 30 % shorter installation depth

- Permanent-Aktivrückzug
- Press- und Rückzugskraft extrem hoch
- Permanent-Active retraction
- Extremely high pressing and retracting force

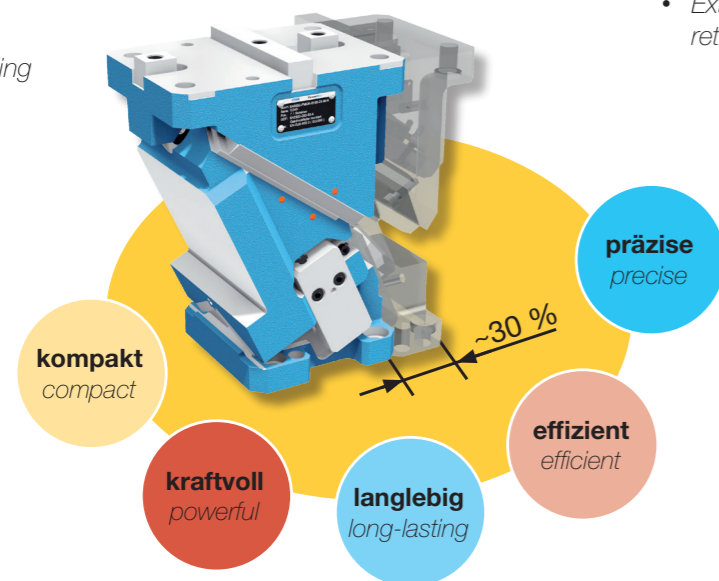

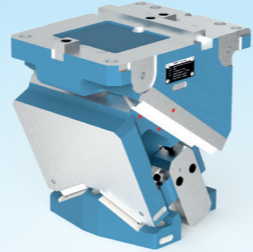
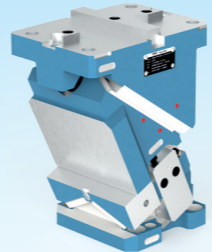
Hochleistungsschieber / High-performance cam unit	
PMO	PMOK
	

- ▶ Breiten von 65-1200mm (PMO) und 65-460 mm (PMOK)
- ▶ Arbeitswinkel 0-75°
- ▶ Durchschnittliche Lebensdauer: 2 Mio.
- ▶ Garantierte Standzeit: 1 Mio.
- ▶ Widths from 65-1200 mm (PMO) and 65-460 mm (PMOK)
- ▶ Working angle 0-75°
- ▶ Average lifetime: 2 million
- ▶ Guaranteed service life: 1 million

E0 	E1 
G0  Standard  	G1  
S0  	S1  

W = Schieberwinkel
Cam Angle

G = Gasdruckfeder
Gas spring

E = Einarbeitung
Machining



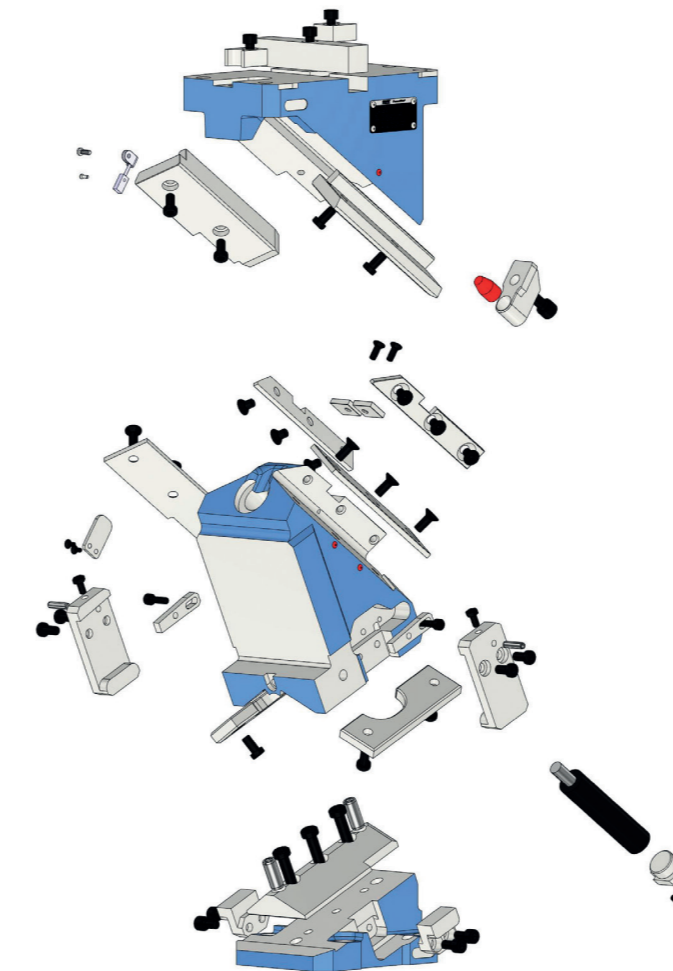



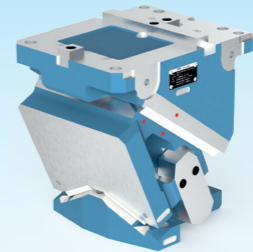
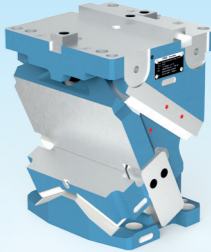



SE = Sensor
Sensor



Freigaben der Autohersteller / Approvals of the car manufacturers: https://www.strack.de/de/powermax_freigaben/

Lightschieber / Light cam unit	
PMOL	PMOKL
	

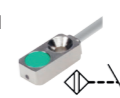
- ▶ Breiten von 65-1200 mm (PMOL) und 65-460 mm (PMOKL)
- ▶ Arbeitswinkel 0-75°
- ▶ Durchschnittliche Lebensdauer: 1 Mio.
- ▶ Garantierte Standzeit: 500.000
- ▶ Widths from 65-1200 mm (PMOL) and 65-460 mm (PMOKL)
- ▶ Working angle 0-75°
- ▶ Average lifetime: 1 million
- ▶ Guaranteed service life: 500.000

E0 	E1 
G0  Standard  	G1  
S0  	S1  

W = Schieberwinkel
Cam Angle

G = Gasdruckfeder
Gas spring

E = Einarbeitung
Machining

SE = Sensor
Sensor

