

Gesteuerte Gasdruckfedern

Controlled gas springs

Ressorts à gaz contrôlés



Druckmedium	Pressure medium	Médium de pression	Stickstoff (N₂)
Max. Fülldruck	Max. filling pressure	Pression de rempl. max.	105 bar
Min. Fülldruck	Min. filling pressure	Pression de rempl. min.	50 bar
Max. Betriebstemperatur	Max. working temperature	Température de service max.	60 °C
Temperaturabhängige Druckerhöhung	Pressure increase due to temperature	Accroissement de pression sous l'influence de la temp.	0,33 %/°C
Max. Kolbengeschwindigkeit	Max. piston speed	Vitesse max. du piston	0,5 m/s.
Max. empfohlene Hübe	Max. recommended strokes	Course recommandé max.	10 - 35* S/min.
* = Maximale Anzahl abhängig von Arbeitsparametern	* = Maximum rate will depend on working parameters	* = Nombre maximum dépendant des paramètres de travail	

3

Erforderliche Angaben des Kunden

Arbeitshub¹⁾: _____ mm
 Pressengeschwindigkeit: _____ m/min
 Maximale Pressenrate: _____ Hübe/min

¹⁾ Die 100 % Ausnutzung des Hubes **S** reduziert die max. möglichen Arbeitsparameter. 10 % Hubreserve sind in der Werkzeugkonstruktion einzukalkulieren.

Required information of the customer

Working stroke¹⁾: _____ mm
 Press speed: _____ m/min
 Maximum press rate: _____ Strokes/min

¹⁾ The 100 % utilization of the stroke **S** reduces the max. possible working parameters. 10 % stroke reserve is to be calculated in the tool construction.

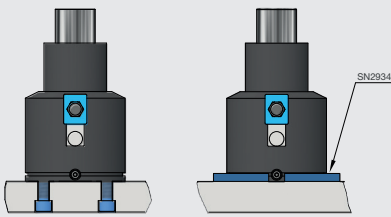

Type 1

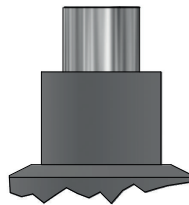

Type 2

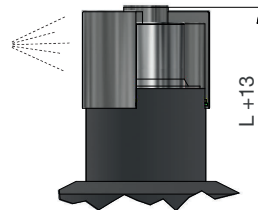

Type 3

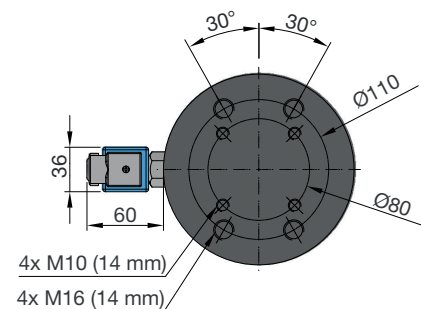
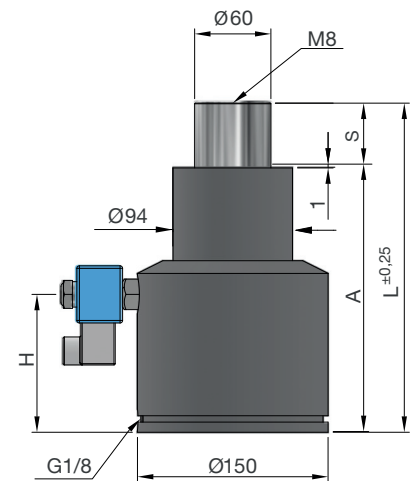
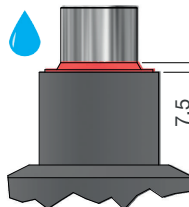

SN2884-3000

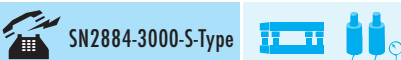

S = Hub¹⁾ / Stroke¹⁾ / Course¹⁾

bar = Fülldruck / Filling pressure / Pression de remplissage



S	Type	A	L	H	daN	daN	bar	Fa [cm ²]
50	1/2/3	208	258	88,5		4065		28,27
75	1/2/3	245	320	100,5	3000 ±5% (20°C)	4465	105 (20°C)	28,27
100	1/2/3	282	382	112,5		4515		28,27
125	1/2/3	319	444	124,5		4655		28,27

D 3002A 07.2024